

AZTEC INSTALLATION GUIDE

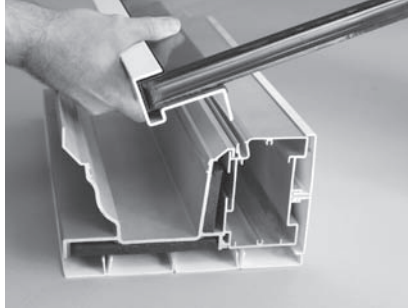

Installation Guide

General

This guide is intended to assist the installation of a typical Edwardian / Victorian roof using the Aztec system, along with additional information on other styles of conservatory roofs. Refer to the Aztec parts and price list to identify part codes and diagrams etc.

Tools Required

Nylon hammer, Cordless drill/driver, tape measure, Hacksaw, Stanley Knife, Low modulus silicone & gun. 4mm drill bit. Spirit level.



Roof may arrive to site already assembled but if it is in kit form start by assembling the ring beam preferably on ground adjacent to the conservatory or on top of the window frames.



Internal and external corner cleats will already be screwed to sections of the ring beam. Slide together and secure with 14 x 25mm self tapping screws. Position brace bars across the beam to secure in place.



Position numbered transom rafters on the side members of the ring beam and locate the pins into the corresponding numbered hole as shown.



Locate the upper ends of the transom rafters into the ridge. The roof assembly will self-support itself without any fixings. All rafters are numbered anticlockwise looking downward.



Continue to locate and offer up the rest of the Rafters. Secure the tops of the rafters by aligning the holes in the ridge or boss with 2 holes in the rafters and secure using 14x25mm self tapping screws from underneath the ridge.



Check the ring beam for square and adjust if necessary before securing the rafters to the ring beam with 14x25mm self tapping screws. If the roof has been assembled on adjacent ground lift the structure onto the frames. Ensure that the frames are plumb and level.



Centralise the roof so the inside edges of the ring beam are flush with the frames drill up through the frame and into the ring beam at a maximum of 500mm centres and fasten with suitable 'combi' screws



Drill through the wall bar into the masonry and secure with anchor bolts. (Ensure that the hole is drilled below the drainage channel as shown on fig3)



Tap the serrated end of the bar cap bracket into the slot at the end of the rafter as shown (see fig 4)



Prepare the flashing by grinding grooves in to the mortar bed progressively at each course with each groove overlapping the previous one.



Position Ridge Flashing AZ528 behind the ridge and into the wall plate channels.



Lead flashing can now be cut, positioned in the grooves and dressed down into the wall plate channel. (see fig 3)

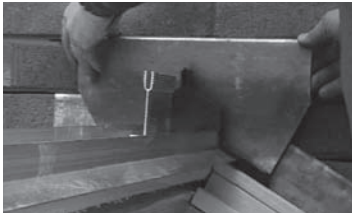

Position lead work into the channel of the ridge flashing. Then seal all leadwork in position with a propriortry sealant. Prior to the ridge cap being fitted apply a bead of silicone sealant to the face of the ridge flashing.

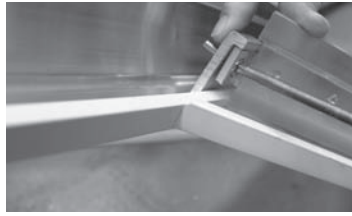

As per the transom rafters locate any jack rafters at the Eaves. Now locate the lip of the 'C' bracket into the hip bar and secure using PZ3 screws.



Twist gutter brackets into the slot of the Ring Beam. Brackets should be placed 200mm from each corner, and no more than 1m apart.



Use only concealed gutter brackets (AZ824) with mill finish Ring Beam. Then fit external Ring Beam Fascia along with external joints to all corners. Clip gutters in place and join with unions.



Apply a bead of silicone sealant along the ridge cap joint (AZ500) on the underside of the external boss cap and slide fully home into the ridge cap (AZ486).



Cut around the edge of the foam bung, back to the rafters to allow the external boss cap to seal against the foam when placed on top.



Position the cap assembly onto the ridge and push down onto the ridge connectors (see fig 1). Snap the crests along the length of the cap. Apply silicone to the underside of the finial and locate onto the boss cap.

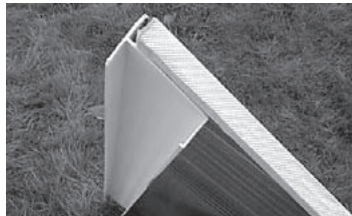

Glazing panel support trims are marked with the same number as the corresponding panel. Identify and push the trim onto the Eaves end of the panel as shown.



Glazing panels are numbered anticlockwise looking downward. Offer the panel up to the ridge and locate into the recess (see fig 1). At the Eaves end ensure that the lip on the trim locates into the groove in the ring beam (see fig 2).



Glaze all ridge panels first, ensuring that the glazing panel is located in the recess of the ridge as shown in fig 1. Finally glaze the hip panels.

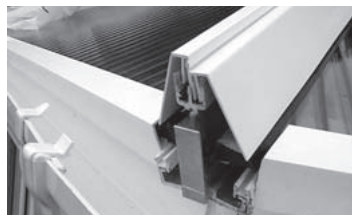

The glazing beads (AZ480/AZ481) are numbered with the corresponding rafter number. Align the bead with the eaves end of the rafter and tap fully home along the length with a nylon/rubber mallet (see fig 4).



Clip the bar end cap (AZ509) over the bracket to close off the rafter. Seal all around the perimeter between the roof and frames with a low modulus silicone sealant.



Internal fascia cladding (AZ373) are knocked onto the ring beam using a rubber mallet (see fig 2). At each corner join the fascias with either a 135 or 90 degree joint. (AZ902/AZ903).



Slide the internal boss cover over the boss plate ensuring that the tongue on the inside face of the cover locates behind the plate.

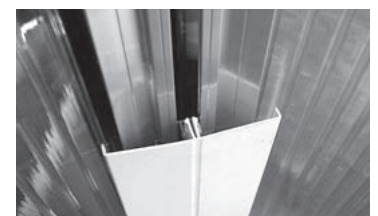

Use internal fascia cladding to cover the ridge by checking the size between internal boss cap and the wall, trimming to length and fixing in place by tapping onto the ridge cladding clips.

Installation Guide

Sealing

Always use low modulus neutral sealant silicone when sealing any aspect of the roof.

Tie Bars

Whenever a tie bar assembly is supplied with the roof it must fitted in line with the manufacturers instructions.

Fig 1 — Ridge Assembly

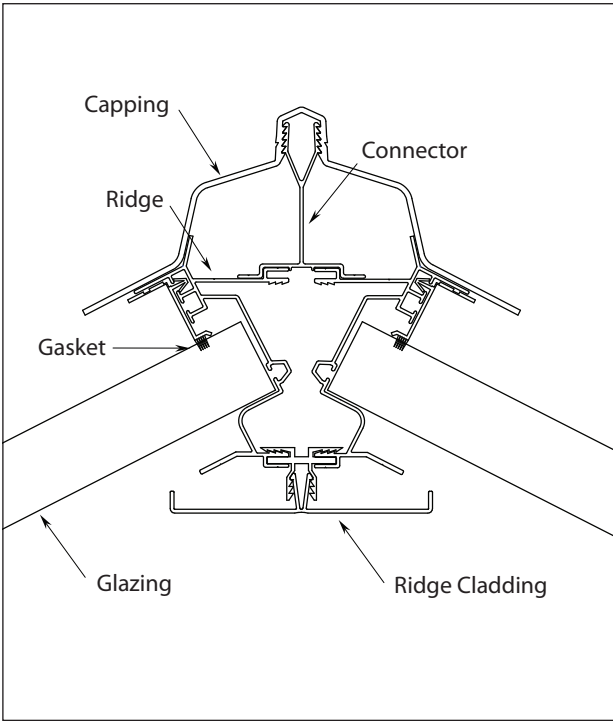

Fig 2 — Eaves Assembly

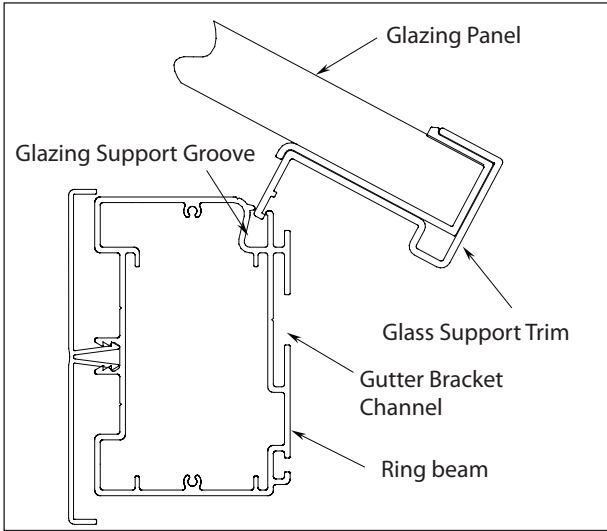

Fig 3 — Wall Bar

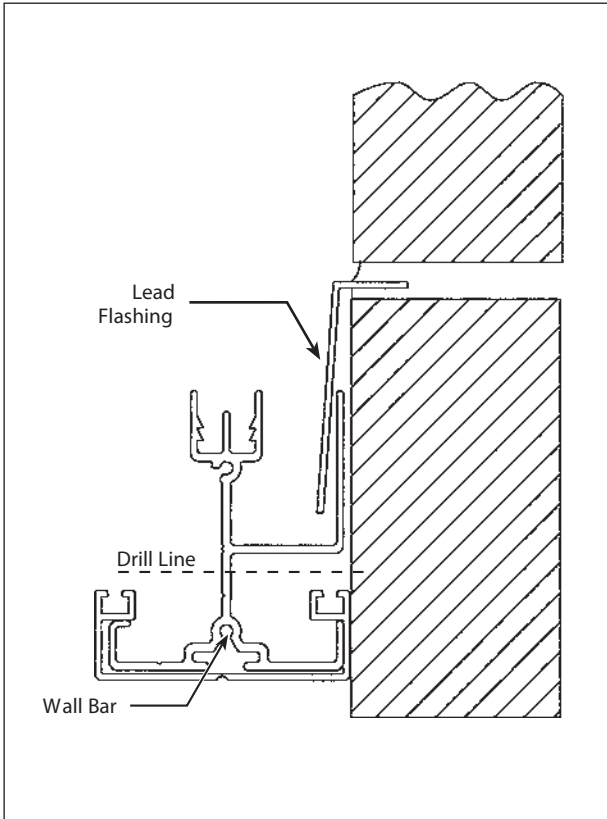

Fig 4 — Transom Assembly

